

WMB3A 03122025

WORKMASTER[®]

WE FIND A WAY — OR MAKE ONE!



GO-B3A

HOPPER CAR GATE OPENER

Address:

284 Three Tun Rd.
Malvern, PA 19355

Phone:

267.350.2809

Email:

info@workmaster.net



The **GO-B3A** is a battery-driven, torque-controlled, portable power tool that produces up to 3000 lbs-ft of torque to open hopper car gates that are easy to moderately-difficult to open. Although the Opener, at 35lbs, is compact and lightweight, because it is a torque wrench, it does require the use of an easy to attach torque reaction arm for safety. The GO-B3A is supplied with two (2) long lasting HD Lithium-Ion batteries which, if properly maintained, will open hundreds of hopper cars for years. The GO-B3A is ideal for:

- Unloading sites that receive occasional to light hopper car traffic;
- Railcars that vary from easy-to-open to moderately difficult;
- Neither compressed air nor electric power is available or is limited;
- Majority of railcars have fixed position gate mechanisms;
- Trackside surface is level, smooth, and unobstructed;
- Narrow decks or platforms preclude wheeled-cart or beam-mounted Opener;
- Site security requires portable, easy to remove and store tools

THE GO-B3A

THE GO-B3A GENERATES AN OPERATOR PACED MAXIMUM POWER OUTPUT OF 3,000 LBS-FT.

Simply align the **GO-B3A** perpendicular to the railcar's Capstan Socket and firmly seat the Capstan Drive Fitting into the car's Capstan Socket.

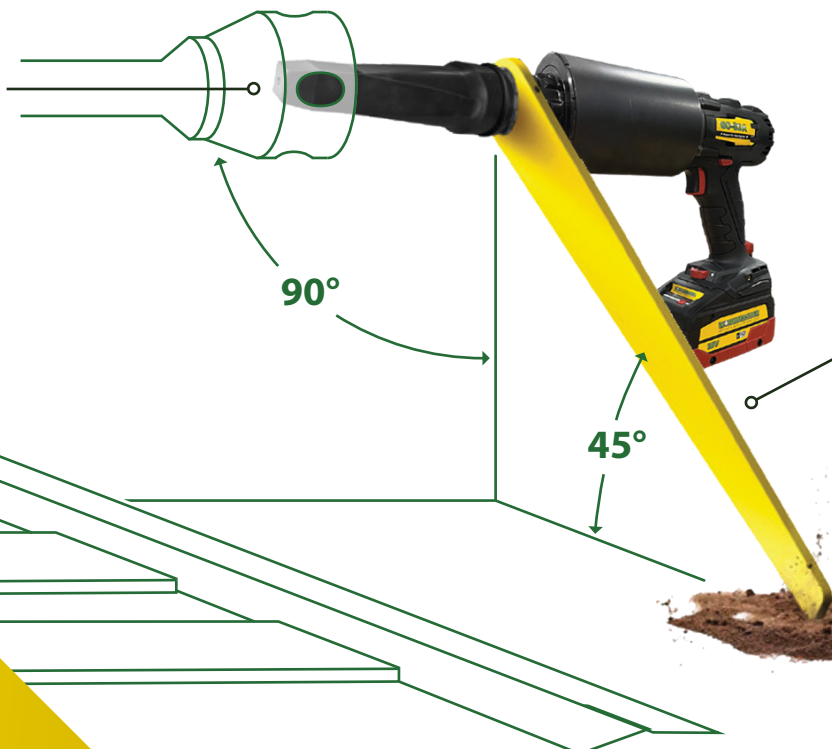

The **Torque Reaction Arm** securely positions itself against the ground or a stationary object with the press of a trigger.

GO-B3A

HOPPER CAR GATE OPENER

WORKMASTER
WE FIND A WAY — OR MAKE ONE!



SPECIFICATIONS

MODEL	GO-B3A Battery Powered Gate Opener
SQUARE DRIVE	1"
MIN.TORQUE	650 lbs-ft
MAX TORQUE	3000 lbs-ft
WEIGHT (Tool; Drive Fitting; Battery)	23.7 lbs
WEIGHT (Tool; Drive Fitting; Battery; Reaction Arm)	35.05 lbs
RPM at Min. Torque	2.25
RPM at Max Torque	3.25
Charger Requirements	120V/1Ph/50-60Hz or 240V/1Ph/50-60Hz
Included	(1) Capstan Drive Fitting w/ Pin & O-Ring Retainer; (1) Torque Reaction Arm w/ socket head shoulder bolt and 1/8" Hex Key; (2) HD Li-Ion Batteries; (1) Battery Charger; (1) Sturdy Carrying Bag; (1) Owner/Operator's Manual
Shipping Weight	40 lbs

BATTERY POWERED

Operates at sites where air or electric power is not available.

LIGHTWEIGHT PORTABILITY

Enables one worker to easily carry and position this 35.05 lb powerhouse in the gate's capstan, and thereby improve safety, increase productivity, and reduce costs.

QUICK CHARGE BATTERY

Lithium-Ion HD Battery fully charges in under 60 minutes.

SMOOTH, CONTINUOUS FORCE

Facilitates steady, controlled gate opening without concern for wear of gate mechanism.

STURDY CARRYING BAG

Allows convenient storage of all components, and easy transport to/from the unloading site.



Workmaster® line of Hopper Car Unloading Products

Ranging from our wide selection of railcar gate openers to our railcar vibrators, we offer total solutions to the vexing problems of unloading hopper cars.

GO-B3A Features

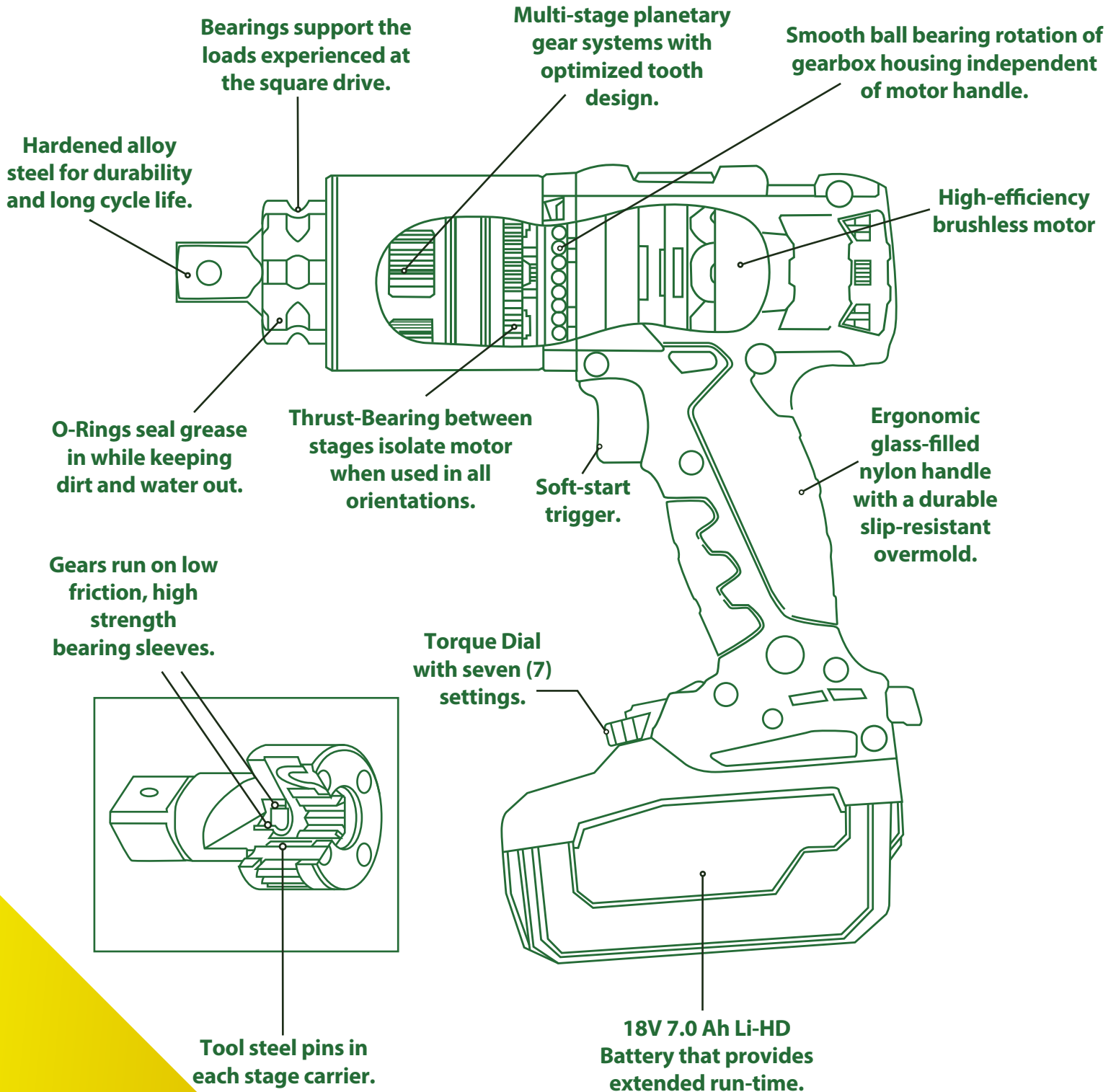

GO-B3A

HOPPER CAR GATE OPENER

WORKMASTER
WE FIND A WAY — OR MAKE ONE!



ITEM	P/N	DESCRIPTION
1	33-B3015	Torque Tool
2	33-01210	Capstan Drive Fitting w/ Pin & O-ring
3	33-B3008	Torque Reaction Arm
4*	32-50004	O-Ring Retainer
5*	32-50123	Retaining Pin
6	33-B3002	Li Ion Battery (Qty 2)
7**	33-B3005	Shoulder Bolt
8	33-B3009	Battery Charger
9	33-B3006	Hex Key
10	32-90022	Utility Bag

*Included w/ 33-01210

** Included w/ 33-B3008

GO-B3A Dimensions

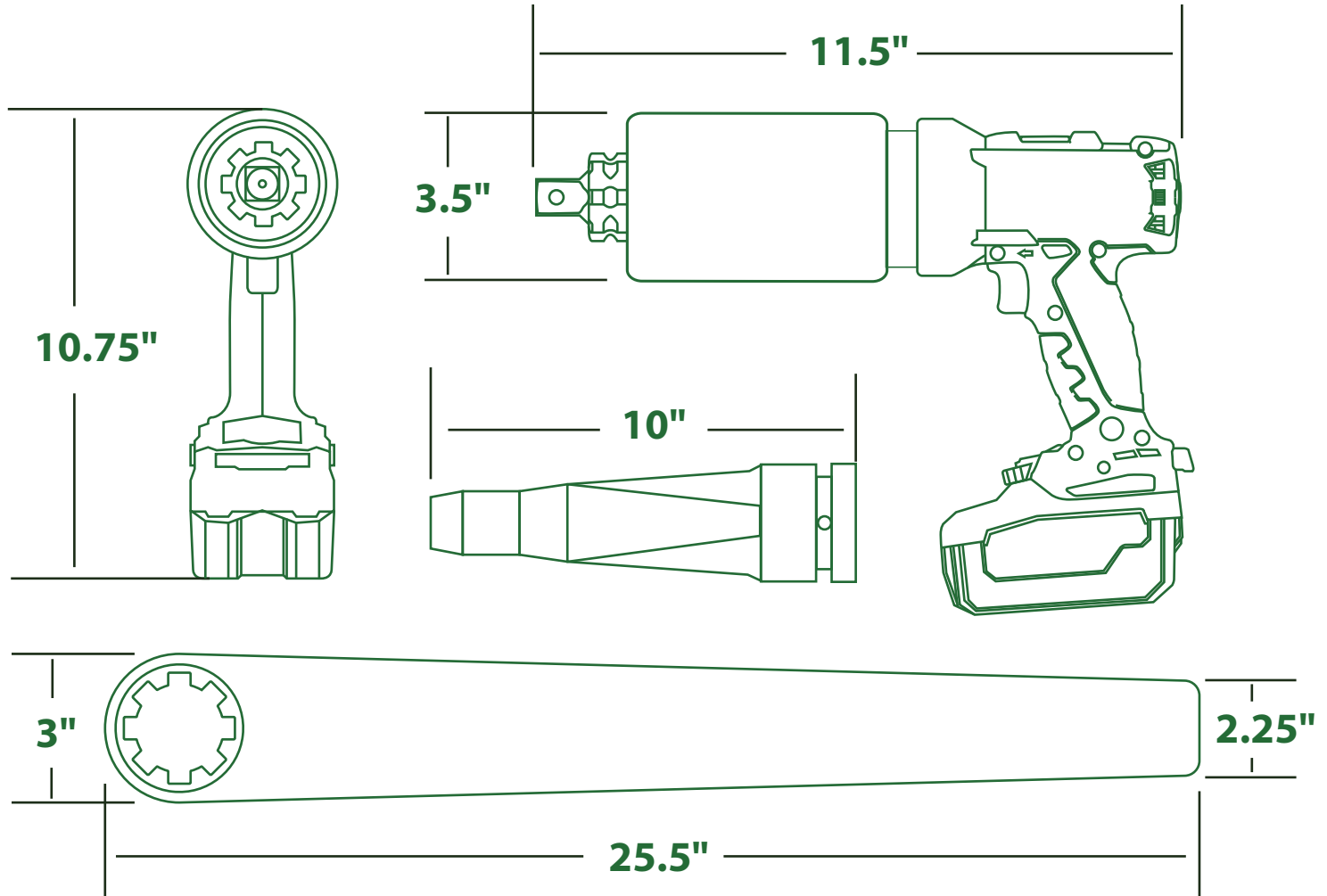

HOPPER CAR GATE OPENERS

WORKMASTER
WE FIND A WAY — OR MAKE ONE!



GO-A8-PW

The WORKMASTER GO-A8-PW is an air-powered Railcar Gate Opener on a wheeled-cart with pneumatic controlled pivot wheels and manual height adjustment.



GO-A13-HA

The WORKMASTER GO-A13-HA is an air-powered Railcar Gate Opener on a wheeled-cart with pneumatic control of both its pivot wheels and height adjustment.



GO-A8-FW

The WORKMASTER GO-A8-FW is an air-powered Railcar Gate Opener on a wheeled-cart with manual height adjustment.



GO-A3-PW

The WORKMASTER GO-A3-PW is an air-powered Railcar Gate Opener on a wheeled cart with manual control of both its pivot wheels and height adjustment. It does generate torque reaction and needs to be stabilized.



GO-E2

The WORKMASTER GO-E2 is an electric powered Railcar Opener with rolling carriage (for mounting to a secured-to-ground W6 x 20 trackside beam), utilizing pendant controlled, instant forward / reverse action, and manual adjustment of a telescoping drive shaft and angles 50° vertical or horizontal.



GO-A2

The WORKMASTER GO-A2 is an air-powered, hand-portable, compact Railcar Opener with hand-held controls for rapid Forward-Reverse action.



GO-M3

The WORKMASTER GO-M3 is a manual-powered, hand-portable, compact Railcar Opener that rests on the ground while engaged in a railcar capstan. The GO-M3, a heavy-duty torque multiplier.



GO-M04

The WORKMASTER GO-M04 is a compact, portable and economical, manual ratchet wrench style railcar opener that is best used when budget is limited or railcar unloading is infrequent.



CAPSTAN REPAIR

Opening slide gates with a completely worn Capstan Barrel is a problem. When the Barrel is rounded-off, it resists any effort to get a grip with a Drive Fitting. We have 2 solutions to the problem.

WORKMASTER®

WE FIND A WAY — OR MAKE ONE!

WORKMASTER specializes in manufacturing labor-saving bulk material handling tools designed to facilitate the safe and efficient unloading, transport, storage, and processing of bulk solids. Catering to the needs of the agriculture, manufacturing, mining, and concrete construction sectors, **WORKMASTER** provides a distinctive line of bulk solids handling equipment. Our innovative products empower plant workers to safely accomplish tasks effortlessly and swiftly such as opening and unloading hopper bottom railcars and dry bulk trailers, ensuring the smooth flow of material from bins and silos, and improving the consolidation and finishing of freshly poured concrete through form, table, and surface vibration techniques. Our products play a pivotal role in enhancing safety and efficiency for our customers, while also extending the lifespan of critical production equipment. By reducing operating and maintenance costs, our tools prove invaluable for tackling some of the industry's most hazardous, challenging, and demanding tasks.



Address: 284 Three Tun Rd.
Malvern, PA 19355
Phone: 267.350.2809
Email: info@workmaster.net